

DESCRIPTION

The Galleon™ wall and pedestrian LED luminaire's appearance is complementary with the Galleon area and site luminaire bringing a modern architectural style to lighting applications. Flexible mounting options accommodate wall surfaces, pole, and mast arm applications allowing it to be offered as a pedestrian or site lighting, solution. The Galleon family of LED products deliver exceptional performance with patented, high-efficiency AccuLED Optics™, providing uniform and energy conscious lighting for parking lots, building and security lighting applications.

SPECIFICATION FEATURES

Construction

Driver enclosure thermally isolated from optics for optimal thermal performance. Heavy wall aluminum housing die-cast with integral external heat sinks to provide superior structural rigidity and an IP66 rated housing. Overall construction passes a 1.5G vibration test to ensure mechanical integrity.

Optics

Choice of thirteen patented, high-efficiency AccuLED Optics. The optics are precisely designed to shape the distribution maximizing efficiency and application spacing. AccuLED Optics create consistent distributions with the scalability to meet customized application requirements. Offered standard in 4000K (+/- 275K) CCT and minimum 70 CRI. Optional 6000K and 3000K CCT. Greater than 90% lumen

maintenance expected at 60,000 hours. Available in standard 1A drive current and optional 530mA and 700mA drive currents.

Electrical

LED drivers are mounted for ease of maintenance. 120-277V 50/60Hz, 347V or 480V 60Hz operation. 480V is compatible for use with 480V Wye systems only. Drivers are provided standard with 0-10V dimming. An optional Eaton proprietary surge protection module is available and designed to withstand 10kV of transient line surge. The Galleon Wall LED luminaire is suitable for operation in -30°C to 40°C ambient environments. For applications with ambient temperatures exceeding 40°C, specify the HA (High Ambient) option.

Mounting

In addition to wall mounting, the innovative quick mounting arm attaches to new or existing 4-5" round or square poles with 1-1/2" to 4-7/8" drilling patterns without re-drilling. Optional mast arm adapter fits horizontal 2-3/8" tenon.

Finish

Housing finished in super durable TGIC polyester powder coat paint, 2.5 mil nominal thickness for superior protection against fade and wear. Standard colors include black, bronze, grey, white, dark platinum and graphite metallic. RAL and custom color matches available. Consult the McGraw-Edison Architectural Colors brochure for the complete selection.

Warranty

Five-year warranty.

Catalog #		Type
Project		
Comments		Date
Prepared by		



GWC GALLEON WALL AND PEDESTRIAN LUMINAIRE

1-2 Light Squares
Solid State LED

WALL AND POLE MOUNT LUMINAIRE

DIMENSIONS

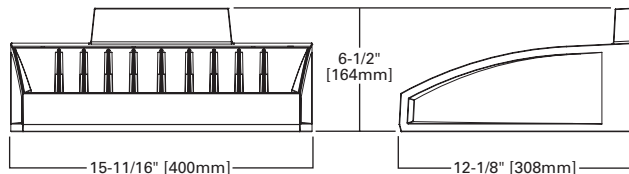

MAST ARM MOUNT

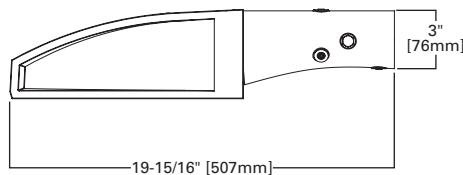

QUICK MOUNT ARM (OVERALL DIMENSIONS)

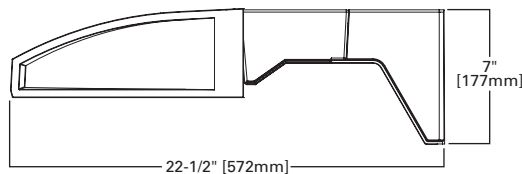

BATTERY BACKUP AND THRU-WIRE BACKBOX

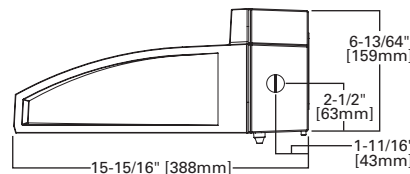

HOOK-N-LOCK MOUNTING

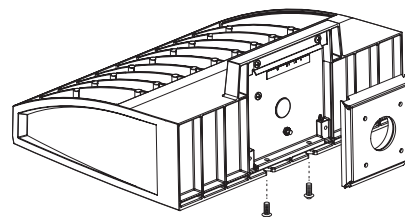

QUICK MOUNT ARM (POLE MOUNTING DETAILS)

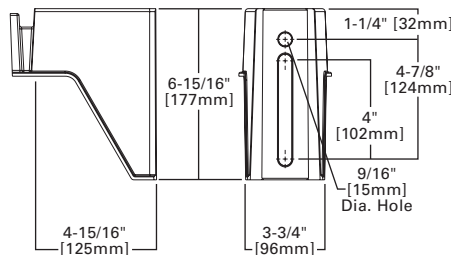

CERTIFICATION DATA

UL/cUL Listed
LM79 / LM80 Compliant
IP66 Housing
ISO 9001
DesignLights Consortium™ Qualified*

ENERGY DATA

Electronic LED Driver
>0.9 Power Factor
<20% Total Harmonic Distortion
120-277V/50 & 60Hz, 347V/60Hz, 480V/60Hz
-30°C Minimum Temperature
40°C Ambient Temperature Rating

SHIPPING DATA

Approximate Net Weight:
27 lbs. (12.2 kgs.)

POWER AND LUMENS

Number of Light Squares	1			2			
	530mA	700mA	1A	530mA	700mA	1A	
Drive Current	530mA	700mA	1A	530mA	700mA	1A	
Power (Watts)	29W	39W	56W	58W	77W	112W	
Input Current @ 120V (mA)	270	350	510	490	650	960	
Input Current @ 208V (mA)	160	210	300	280	380	560	
Input Current @ 240V (mA)	140	180	260	250	330	480	
Input Current @ 277V (mA)	120	160	230	210	280	420	
Power (Watts)	36W	46W	68W	65W	83W	123W	
Input Current @ 347V (mA)	110	140	200	190	240	360	
Input Current @ 480V (mA)	320	410	580	550	700	1,040	
Optics							
T2	Lumens	3,195	4,000	5,472	6,297	7,881	10,783
	BUG Rating	B1-U0-G1	B1-U0-G1	B1-U0-G1	B1-U0-G2	B1-U0-G2	B2-U0-G2
T3	Lumens	3,228	4,041	5,528	6,362	7,963	10,894
	BUG Rating	B1-U0-G1	B1-U0-G1	B1-U0-G2	B1-U0-G2	B1-U0-G2	B2-U0-G2
T4FT	Lumens	3,237	4,051	5,543	6,378	7,983	10,922
	BUG Rating	B1-U0-G1	B1-U0-G1	B1-U0-G2	B1-U0-G2	B1-U0-G2	B2-U0-G2
T4W	Lumens	3,190	3,992	5,462	6,285	7,867	10,763
	BUG Rating	B1-U0-G1	B1-U0-G1	B1-U0-G2	B1-U0-G2	B1-U0-G2	B2-U0-G2
5MQ	Lumens	3,405	4,262	5,831	6,710	8,398	11,490
	BUG Rating	B2-U0-G1	B2-U0-G1	B3-U0-G1	B3-U0-G1	B3-U0-G2	B3-U0-G2
5WQ	Lumens	3,455	4,324	5,917	6,809	8,522	11,659
	BUG Rating	B2-U0-G1	B3-U0-G1	B3-U0-G1	B3-U0-G2	B3-U0-G2	B4-U0-G2
5NQ	Lumens	3,319	4,154	5,684	6,540	8,186	11,200
	BUG Rating	B2-U0-G0	B2-U0-G0	B2-U0-G1	B2-U0-G1	B3-U0-G1	B3-U0-G1
SL2	Lumens	3,120	3,905	5,343	6,149	7,696	10,529
	BUG Rating	B1-U0-G1	B1-U0-G1	B1-U0-G2	B1-U0-G2	B2-U0-G2	B2-U0-G2
SL3	Lumens	3,152	3,945	5,397	6,211	7,773	10,635
	BUG Rating	B1-U0-G1	B1-U0-G1	B1-U0-G2	B1-U0-G2	B1-U0-G2	B1-U0-G2
SL4	Lumens	3,037	3,801	5,200	5,984	7,490	10,247
	BUG Rating	B0-U0-G1	B1-U0-G1	B1-U0-G2	B1-U0-G2	B1-U0-G2	B1-U0-G2
SLL/SLR	Lumens	2,751	3,444	4,711	5,422	6,786	9,284
	BUG Rating	B1-U0-G1	B1-U0-G1	B1-U0-G1	B1-U0-G1	B1-U0-G2	B1-U0-G2
RW	Lumens	3,250	4,068	5,565	6,404	8,016	10,967
	BUG Rating	B2-U0-G2	B2-U0-G2	B2-U0-G2	B3-U0-G3	B3-U0-G3	B3-U0-G3

OPTICAL DISTRIBUTIONS

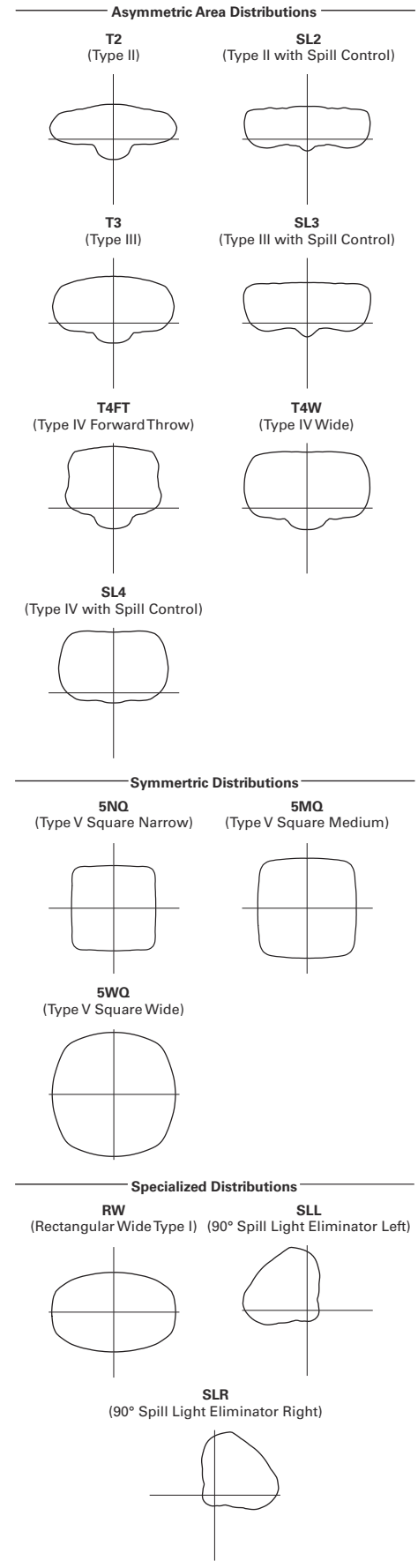

LUMEN MAINTENANCE

Ambient Temperature	TM-21 Lumen Maintenance (60,000 Hours)	Theoretical L70 (Hours)
25°C	> 94%	> 350,000
40°C	> 93%	> 250,000
50°C	> 90%	> 170,000

* 50°C lumen maintenance data applies to 530mA and 700mA drive currents.

LUMEN MULTIPLIER

Ambient Temperature	Lumen Multiplier
0°C	1.02
10°C	1.01
25°C	1.00
40°C	0.99
50°C	0.97

COLOR TEMPERATURE

Color Temperature (CCT)	Color Rendering Index (CRI)	Multiplier
3000	70	0.91
4000	70	1.00
5000	70	1.03
5700	70	1.03

ORDERING INFORMATION

Sample Number: GWC-AE-02-LED-E1-T3-GM

Product Family ¹	Light Engine	Number of Light Squares ²	Lamp Type	Voltage	Distribution	Color	Mounting Options
GWC=Galleon Wall	AE=1A Drive Current	01=1 02=2 ³	LED=Solid State Light Emitting Diodes	E1=120-277V 347=347V ⁴ 480=480V ^{4,5}	T2=Type II T3=Type III T4FT=Type IV Forward Throw T4W=Type IV Wide SL2=Type II w/Spill Control SL3=Type III w/Spill Control SL4=Type IV w/Spill Control SLL=90° Spill Light Eliminator Left SLR=90° Spill Light Eliminator Right RW=Rectangular Wide Type I 5NQ=Type V Square Narrow 5MQ=Type V Square Medium 5WQ=Type V Square Wide	AP=Grey BZ=Bronze BK=Black DP=Dark Platinum GM=Graphite Metallic WH=White CC=Custom Color ⁶	MA=2-3/8" Mast Arm ^{7,8} QM=Quick Mount Arm for Round or Square Pole ^{7,9}
Options (Add as Suffix)					Accessories (Order Separately)		
530=Drive Current Factory Set to 530mA 700=Drive Current Factory Set to 700mA P=Button Type Photocontrol (120, 208, 240 or 277V) R=NEMA Twistlock Photocontrol Receptacle PER7=NEMA 7-PIN Twistlock Photocontrol Receptacle ^{10,11} LCF=Light Square Trim Plate Painted to Match Housing ¹³ 7030=70 CRI / 3000K ¹⁴ 7050=70 CRI / 5000K ¹⁴ 7060=70 CRI / 6000K ¹⁴ L90=Optics Rotated 90° Left R90=Optics Rotated 90° Right DIMRF-LW=LumaWatt Wireless Sensor, Wide Lens for 8' - 16' Mounting Height ^{15,16} DIMRF-LN=LumaWatt Wireless Sensor, Narrow Lens for 16' - 40' Mounting Height ^{15,16} MS-LXX=Motion Sensor for On/Off Operation ^{17,19} MS/DIM-LXX=Motion Sensor for Dimming Operation ^{17,18,19} DIM=0-10V Dimming Drivers ^{10,20} HSS=Factory Installed House Side Shield ²¹ HA=50°C High Ambient ²² F=Single Fused (120, 277 or 347V. Must Specify Voltage) FF=Double Fused (208, 240 or 480V. Must Specify Voltage) 10K=10kV Surge Module Dali=Dali Driver ²³ CE=CE Marking and Small Terminal Block ²⁴ MT=Factory Installed Mesh Top					OA/RA1013=Photocontrol Shorting Cap OA/RA1016=NEMA Photocontrol - Multi-Tap 105-285V OA/RA1201=NEMA Photocontrol - 347V OA/RA1027=NEMA Photocontrol - 480V MA1252=10kV Circuit Module Replacement FSIR-100=Wireless Configuration Tool for Occupancy Sensor ¹⁹		

- NOTES:**
- DesignLight Consortium™ Qualified. Refer to www.designlights.org Qualified Products List under Family Models for details.
 - Standard 4000K CCT and minimum 70 CRI.
 - Two light squares with BBB or CWB options uses two drivers and limited to 25°C, 120-277V only.
 - Requires the use of a step down transformer.
 - Only for use with 480V Wye systems. Per NEC, not for use with ungrounded systems, impedance grounded systems or corner grounded systems (commonly known as Three Phase Three Wire Delta, Three Phase High Leg Delta and Three Phase Corner Grounded Delta systems).
 - Custom colors are available. Setup charges apply. Paint chip samples required. Extended Lead times apply.
 - Customer is responsible for engineering analysis to confirm pole and fixture compatibility for all applications. Refer to our white paper WP513001EN for additional support information.
 - Mast arm adapter factory installed (2-3/8" O.D. arm only). Suitable for 3G vibration.
 - Quick mount arm adapter is factory installed. Pole mounting bracketed shipped in box. Suitable for 1.5G. Fits square and round pole up to 6" O.D.
 - Cannot be used with other control options.
 - Compatible with standard 3-PIN photocontrols, 5-PIN or 7-PIN ANSI controls.
 - Not available with HA option. Operates a single light square only. Cold weather option operates -20°C to +40°C, standard 0°C to +40°C. Backbox is non-IP rated.
 - Not available with HSS option.
 - Extended lead times apply. Use dedicated IES files when performing layouts.
 - LumaWatt wireless sensors are factory installed only requiring network components RF-EM-1, RF-GW-1 and RF-ROUT-1 in appropriate quantities. See www.eaton.com/lighting for LumaWatt application information.
 - Bronze sensor is shipped with Bronze fixtures. White sensor shipped on all other housing color options.
 - Replace LXX with mounting height in feet for proper lens selection (e.g., L8=8' mounting height). L8, L20 and L40 are available options.
 - Includes integral photosensor.
 - The FSIR-100 configuration tool is required to adjust parameters including high and low modes, sensitivity, time delay, cutoff and more. Consult your lighting representative at Eaton for more information.
 - Low voltage control lead brought out 18" outside fixture.
 - Only for use with SL2, SL3 and SL4 distributions. The light square trim plate is painted black when the HSS option is selected.
 - Not available with BBB and CWB options.
 - Only available with BBB or CWB in single light square. HA option available for single light square only.
 - CE is not available with the DIMRF, MS, MS/X, MS/DIM, P, R or PER7 options. Available in 120-277V only.
 - Not available with SL-series distributions.

Coming soon

Options (Add as Suffix)
BBB=Battery Pack with Back Box ^{3,10,12} CWB=Cold Weather Battery Pack with Back Box ^{3,10,12} UPL=Uplight Housing (Not available with Back Box) ²⁵
Accessories (Order Separately)
MA1058XX=Thru-Branch Wiring Back Box (Must Specify Color)